









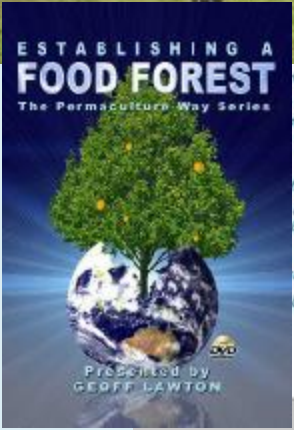
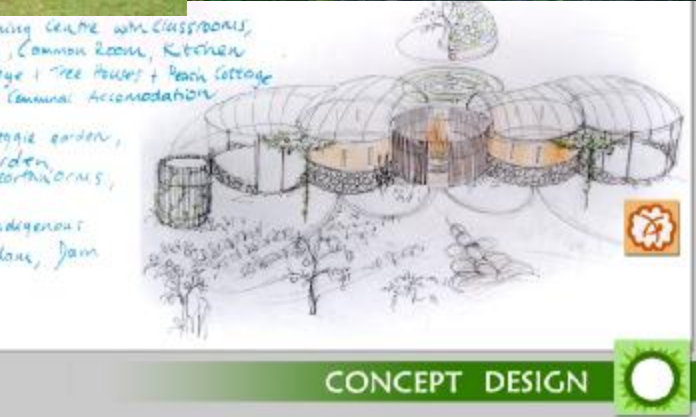

Permaculture Design Course – Honeyville – June/July 2012

A Participative and Interactive Programme

Day Theme	Presentations, discussions, practicals, group design and films	Outcomes
Day 1: Preliminaries	 	<i>Basic Permaculture Design, and, Preparing a basic site Concept Plan</i>
Day 2: Permaculture Design Inspirations		<i>Permaculture Consciousness</i>
Day 3: Sustainability Worldview	 	<i>Integration of Ecological Systems into Permaculture Design</i>
Day 4: Regenerative Agriculture		<i>Designing for Sustainable Communities</i>
Day 5: Farming Systems	  <p data-bbox="1263 1449 1532 1481">CONCEPT DESIGN</p>	<i>Group Design and Individual Design Presentations and Permaculture Networking</i>
Day 6: Water & Waste Water		
Day 7: Soils & Plants		
Day 8: Natural Building Technologies		
Day 9: Energy Descent Planning		
Day 10: Sustainable Communities		
Day 11: Integrate Sustainability		
Day 12: Project Presentations and Closure		

Permaculture Design Process

	<p>1. Site Analysis Status quo assessment:- Land history, local ordinances, surrounding neighbourhood, traffic, utility services, site access, local resources. Physical attributes:- Building structures, trees, hedges, topography, water flows, view sheds. Local biological health:- Native species and their health, intended uses, chemical and biological soil analysis. Local climate:- Sun exposure, sun angles, rainfall, temperature ranges, wind intensity and direction, microclimates, thermal masses. Output: Base Plan</p>
	<p>2. Concept Design Overall long-term vision:- 50 year+ horizon, robust sustainable framework, flexibility and adaption to changes. Zone, elevation and sector plan:- Plan for zones 1 to 5; keyline rainwater harvesting; water recycling; and, sectors for wind, sun, fire, water and wild animals. Natural flows and patterns:- Geonancy, mimic natural flows, flow forms, microclimates, harvest natural energies. "Wild design":- Incorporate at least one wild idea. Output: Concept Plan</p>
	<p>3. Detail Design Refine concept ideas:- Create the design framework and locate the major design fixes. Refine flows and patterns:- Del neate flows and patterns and incorporate within the design framework. Micro-design elements:- Multiple functions, natural energy systems, biological resources. Integrate all design elements:- Create a master layout plan with all design details in accordance with milestone phases. Output: Design Plan</p>
	<p>4. Implementation Resource specification:- Organisational structure, roles and responsibilities, manpower requirements, technical specifications for structures and landscaping, plant lists, seeds, biological resources. Budget estimate:- Schedule of quantities, pricing, taxes, total budget. Gantt chart:- Work breakdown structure, activity scheduling, resource distribution. Commit resources:- Secure budget, contractual arrangements, procurement, brief and deploy work teams, site supervision. Output: Programme & Budget</p>
	<p>5. Operate Maintenance:- Manage the evolution of the master layout design plan, manage planned successions, manage biological resources, co-ordinate work teams, harmonise project beneficiaries, and, financial control. Evaluate:- Continual SWOT analysis of maintenance activities. Tweaking:- Design and implement enhancements. Output: Monitor & Evaluate</p>

www.permaculture2012.co.za

The Permaculture Project Design Process is an incremental approach that empowers students to prepare well thought out and holistic plans.

Examples of 4 Group Design Projects as per the delineated red zones are shown on the next 4 pages.



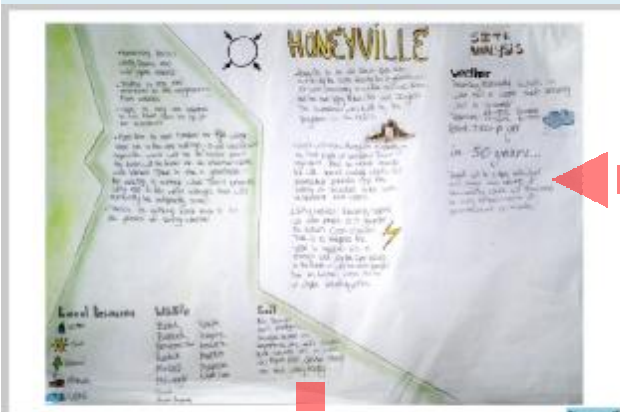

SITE ANALYSIS



SITE ANALYSIS

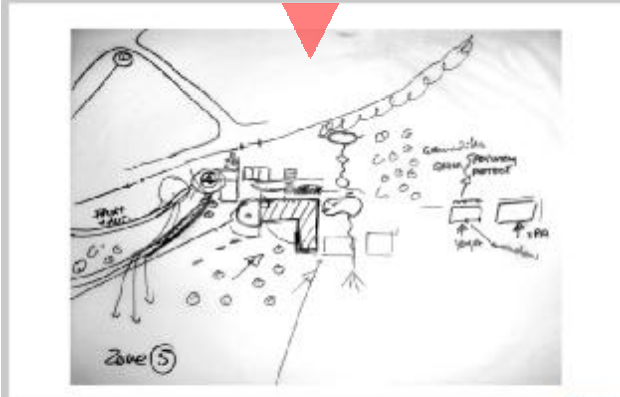

SITE ANALYSIS



CONCEPT DESIGN



CONCEPT DESIGN

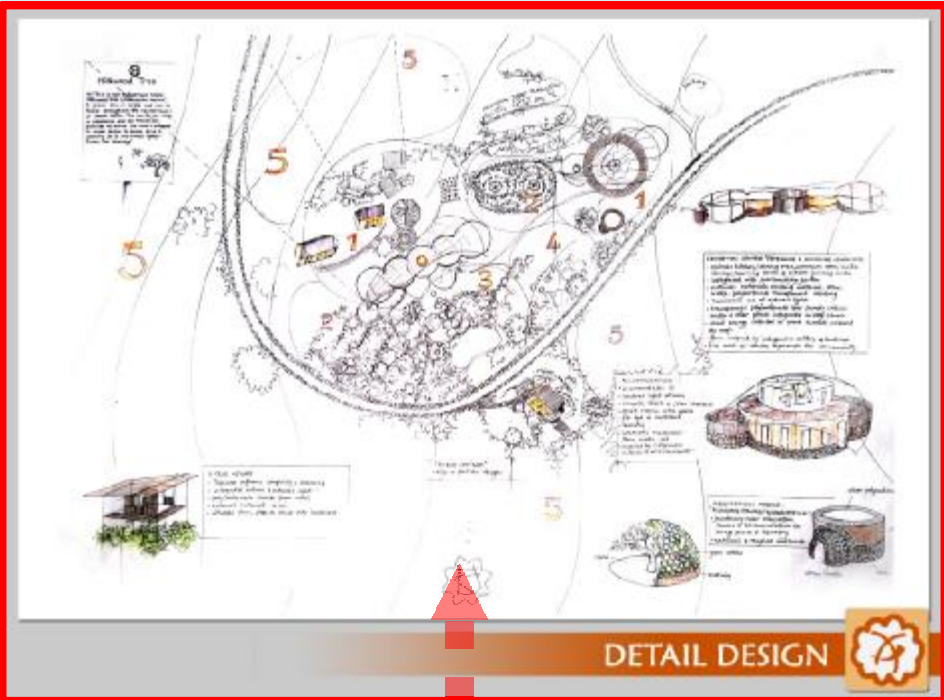

Site analysis

Status Quo

- Land history: 8 year old farm - previously dairy farm
- Local ownership: In own private property
- Surrounding neighbours: Homestead house, dairy farm
- Traffic: Two existing roads
- Utility services: Water pipes, septic tank
- Site access: Main road coming into the site, possibility of more
- Local resources: Many water rich areas, existing structures, a dam, lots of mulching material, good slopes, wood, forest, existing structures, materials for building, human resources

B. Physical attributes

- BUILDING STRUCTURE: 9 existing buildings
- TREES: A few existing indigenous trees + fruit trees
- TOPOGRAPHY: Existing dominant slope that follows the valley floor
- WATER FLOW: Dam with multiple dikes

C. LOCAL BIOLOGICAL HEALTH

- NATIVE SPECIES + HERBICIDES: Mowing along dikes, mowing, spraying, test trees, food garden
- INWOOD USER: Learning Centre + Residence, no
- SOIL ANALYSIS: Very fertile soil, and use of soil + local manure

D. LOCAL CLIMATE

- SUN EXPOSURE: Full sun with possibility of afternoon shade
- SUN ANGLE: [unclear]
- RAINFALL: [unclear]
- RAIN WINDS: West
- TEMPERATURES: WINTER: 15-17°C, SUMMER: 17-30°C
- HART ANGLE: MS OCCURS IN NOV, OCT
- WIND DIRECTION: N-NW, and SE. Limited wind protection

SITE ANALYSIS

CONCEPT DESIGN

VISION: A permaculture campus, a leading permaculture training centre, with residential capacity.

ZONE 1: Learning Centre with classrooms, Media Centre, Common Room, Kitchen

- Dave's Cottage + Tree House + Peach Cottage
- Participants Communal Accommodation

ZONE 2: Veggie garden, kitchen garden, compost + earthworms, nursery

ZONE 3: indigenous swales/bow dams, dam

Zone 4: Food forest next to entrance side

Zone 5: Medicinal trail + natural forest

CONCEPT DESIGN



SITE ANALYSIS



SITE ANALYSIS

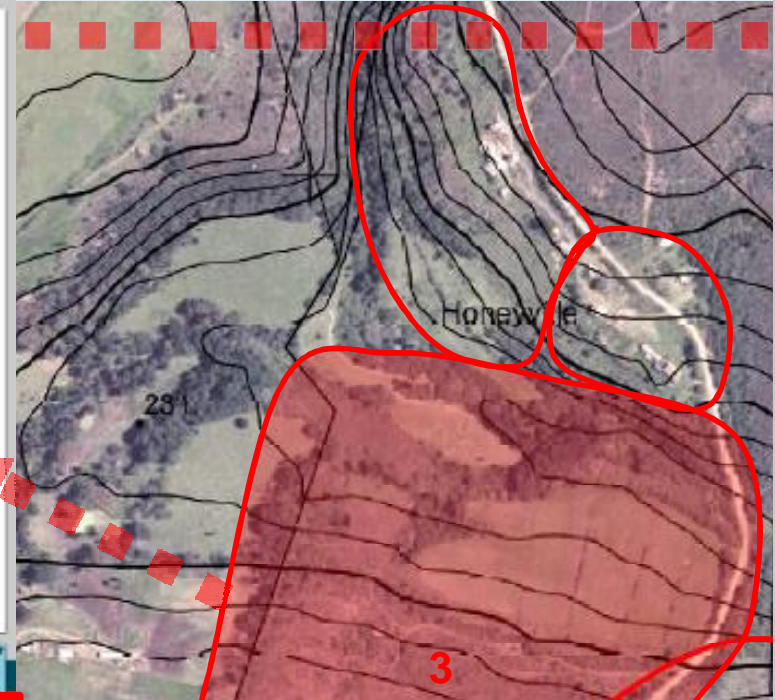

SITE ANALYSIS



CONCEPT DESIGN



CONCEPT DESIGN

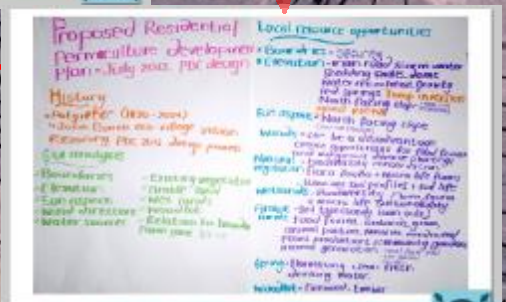

SITE ANALYSIS



CONCEPT DESIGN



CONCEPT DESIGN



SITE ANALYSIS

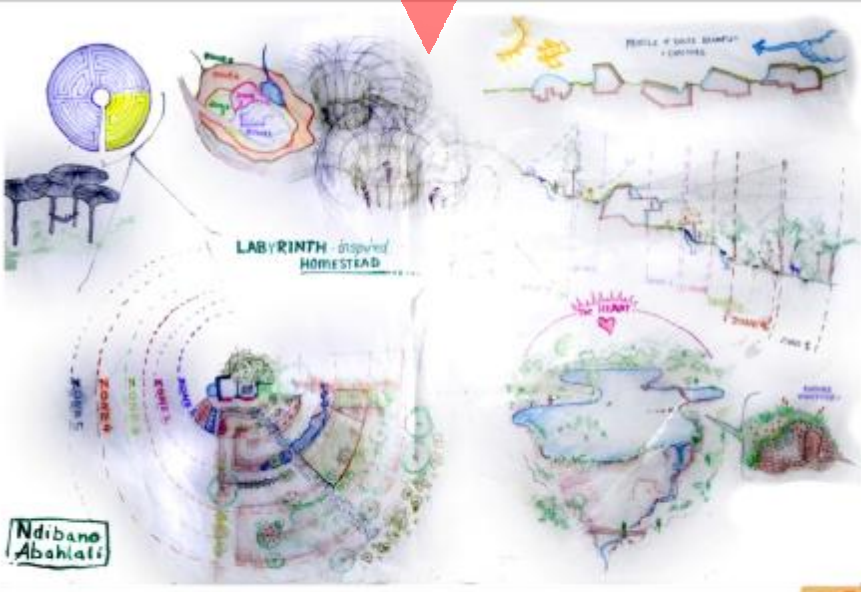

DETAIL DESIGN

